

SANTA CLARA, CA

BUNKER HILL LANE / TASMAN DRIVE

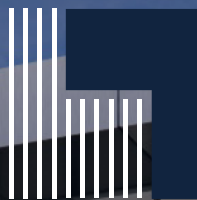

# THE QUAD AT TASMAN

TENANT NAME

6

RENOVATIONS COMING SOON

## WHERE INNOVATION MEETS OPPORTUNITY

±4,786 – ±102,267 SF OF R&D/OFFICE SPACE AVAILABLE



# PROPERTY HIGHLIGHTS

Welcome to The Quad at Tasman, a premier R&D/Office campus strategically located in the heart of Silicon Valley's Golden Triangle. This seven-building campus features state-of-the-art facilities tailored to the needs of innovative tech companies. With cutting-edge amenities and flexible spaces, The Quad at Tasman is designed to support and inspire the next generation of tech pioneers.



3.4/1,000 SF parking ratio with 28 EV charging stations



Ample power at 1,600-2,500 amps 480v per building



Silicon Valley Power cost savings and reliability



14' deck-to-deck with option for 10' drop ceiling



Expansive outdoor amenity space



1 Oz Coffee on-site café serving Monday-Saturday  
**Now Serving Food**



Onsite fitness center



Convenient access to transportation and amenities



ML – light industrial zoning

01.

410,409 SF across 7 buildings

02.

Availability between ±4,786 to ±102,267 SF

03.

Freestanding building identity with building and monument signage



**WELL  
CERTIFIED**



# WORK BEYOND THE WALLS

The expansive outdoor space offers seamless WiFi connectivity and a blend of relaxation and productivity. Tenants can enjoy a café, game and fitness areas, and versatile meeting and collaboration zones, perfect for working or unwinding in a vibrant, open-air setting.



# SITE PLAN

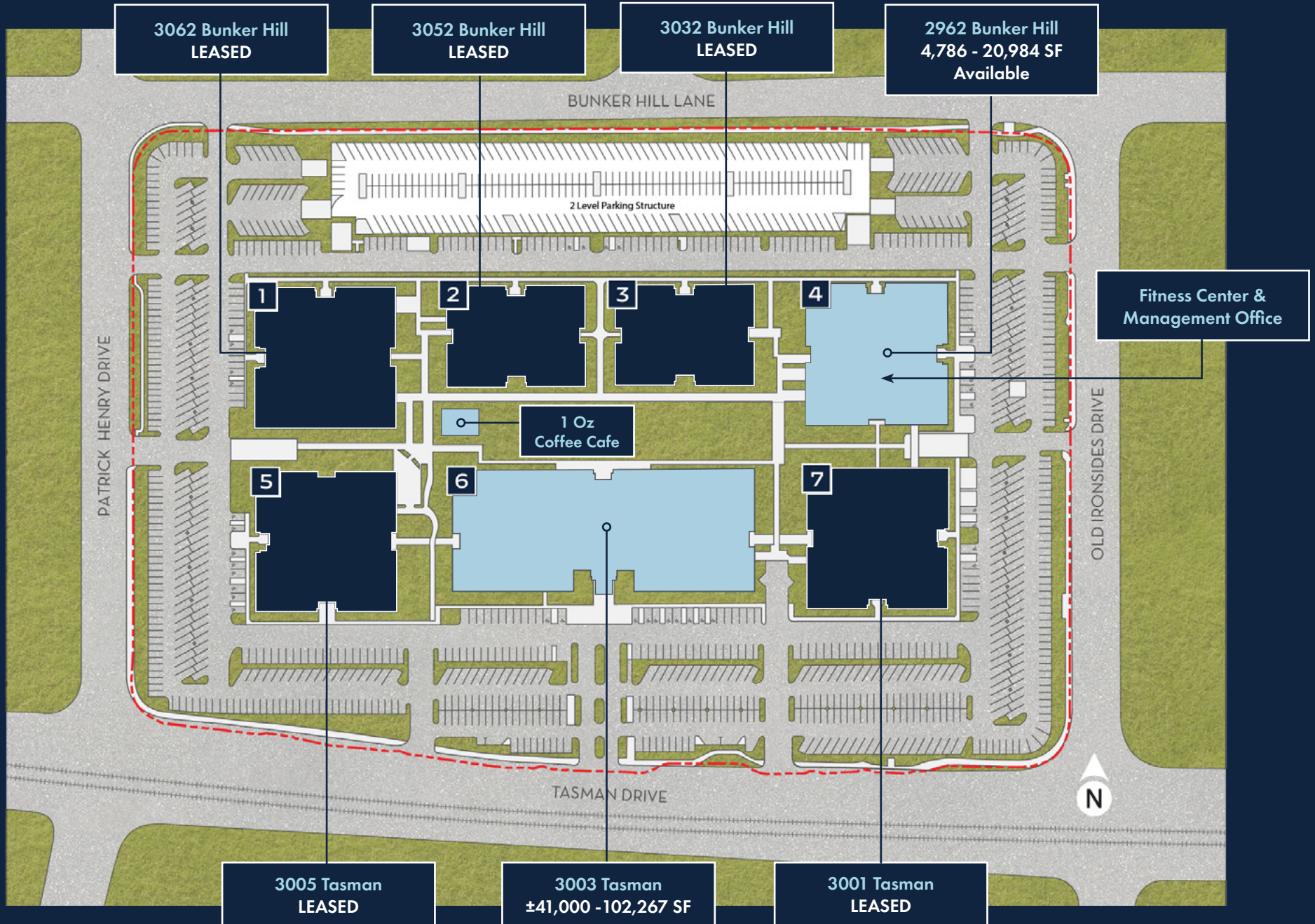

# 3003 TASMAN – PLANNED RENOVATIONS



ENHANCED LOBBY



LOBBY INTERIOR



LOBBY CONNECTION TO CENTRAL QUAD



SECOND FLOOR OVERLOOKING THE LOBBY



# FLOOR PLAN

## BUILDING 6

3003 TASMAN

- 102,267 RSF
- Power: 2,000 amps @ 277/480v
- HVAC: 250 tons
- Grade loading
- Fully furnished plug-n-play

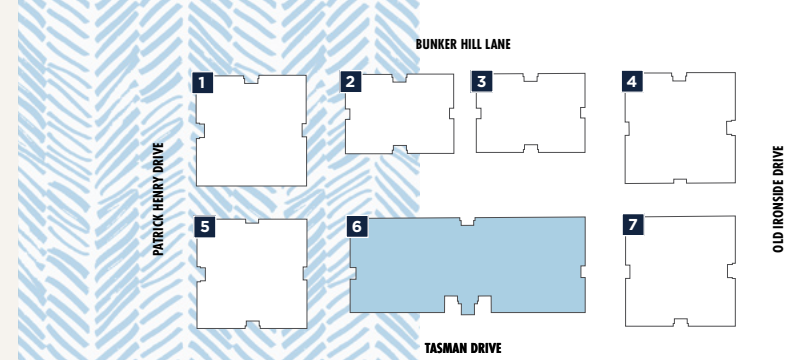

## FLOOR 2

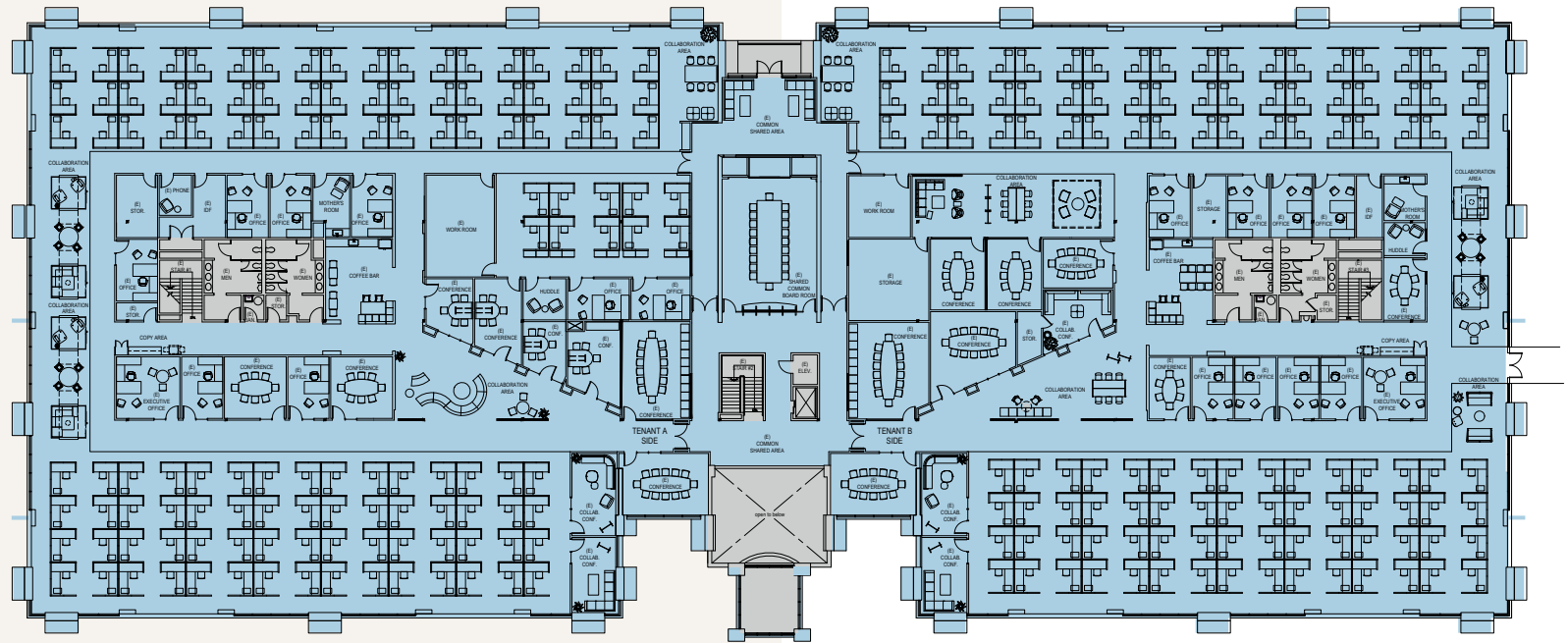

**Suite 06-100**  
Available Now

Work Stations: 242  
Office/Huddle: 20  
Conference: 21

\*Conceptual floor plan with furniture

# FLOOR PLAN

## BUILDING 6

3003 TASMAN

### Demising Options

TENANT A: ±51,000 SF  
TENANT B: ±51,000 SF

#### FLOOR 1



TENANT A  
±25,500 SF

TENANT B  
±25,500 SF

#### FLOOR 2

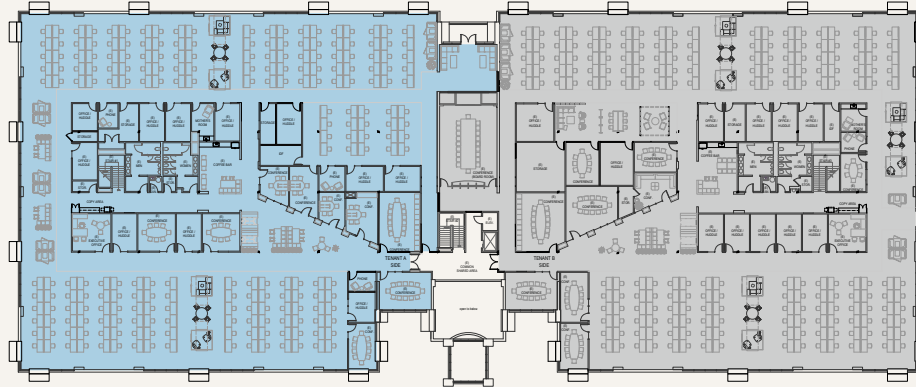

TENANT A  
±25,500 SF

TENANT B  
±25,500 SF

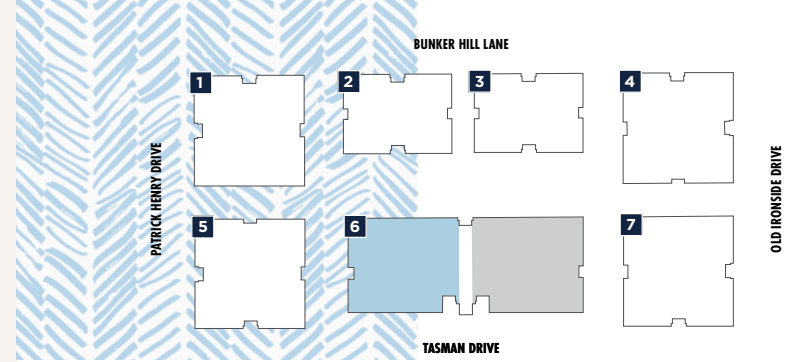

TENANT A: ±41,000 SF  
TENANT B: ±61,000 SF

#### FLOOR 1



TENANT A  
±25,500 SF

TENANT B  
±25,500 SF

#### FLOOR 2



TENANT A  
±15,500 SF

TENANT B  
±35,500 SF

# FLOOR PLAN

## BUILDING 6

3003 TASMAN

### Demising Options

TENANT A: ±76,500 SF

TENANT B: ±25,500 SF

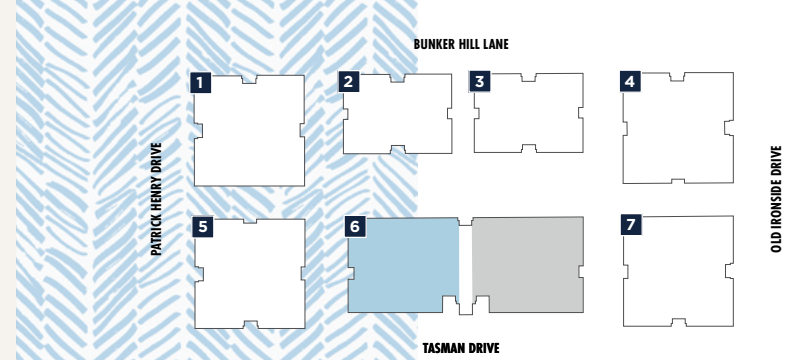

### PLANNED LOBBY RENOVATIONS

#### FLOOR 1



TENANT A  
±25,500 SF

TENANT B  
±25,500 SF

#### FLOOR 2

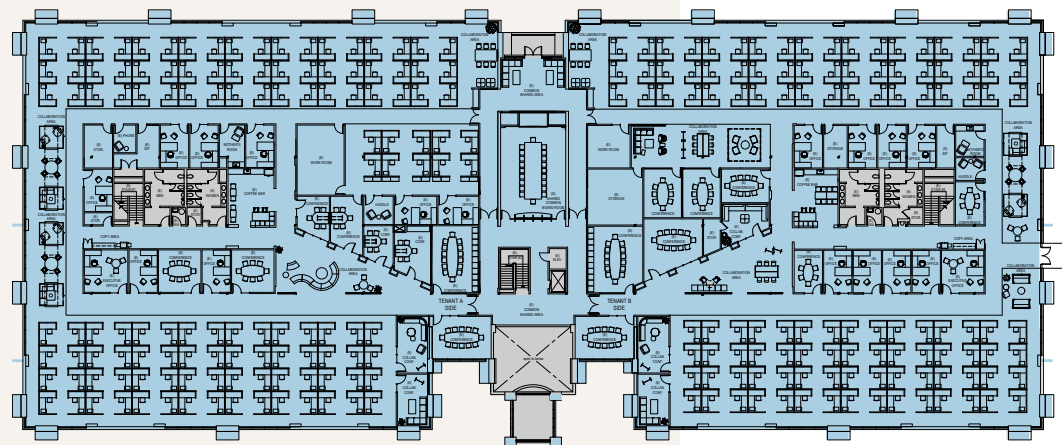

TENANT A  
±51,000 SF

# FLOOR PLAN

## BUILDING 4

2962 BUNKER HILL

- 20,984 RSF (divisible to 4,786 SF)
- Suites 100 & 110 can be combined to ±15,811 SF

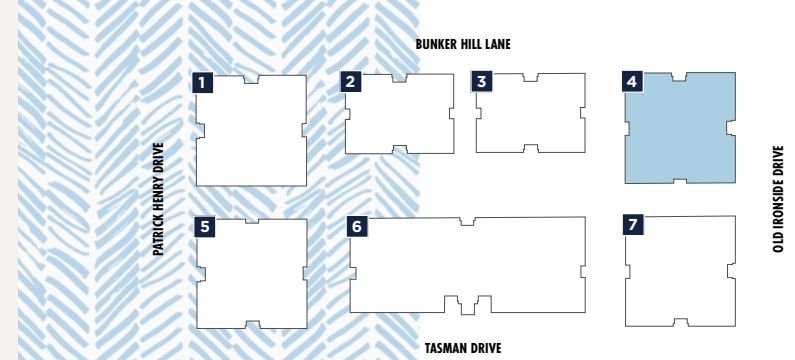

### AS-BUILT PLAN

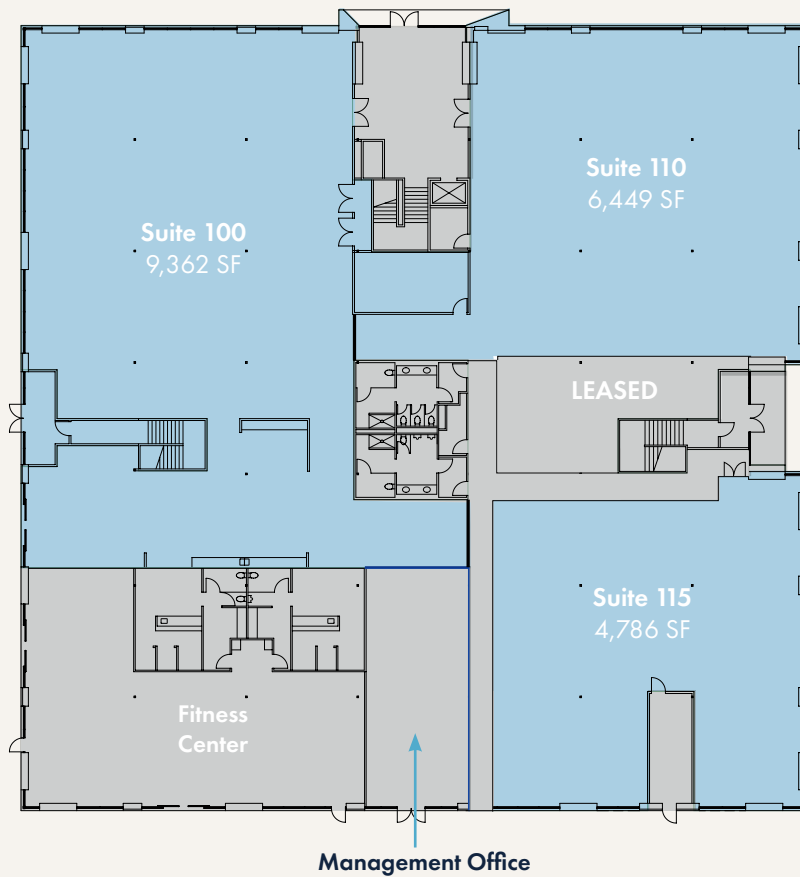

### CONCEPTUAL SPACE PLAN

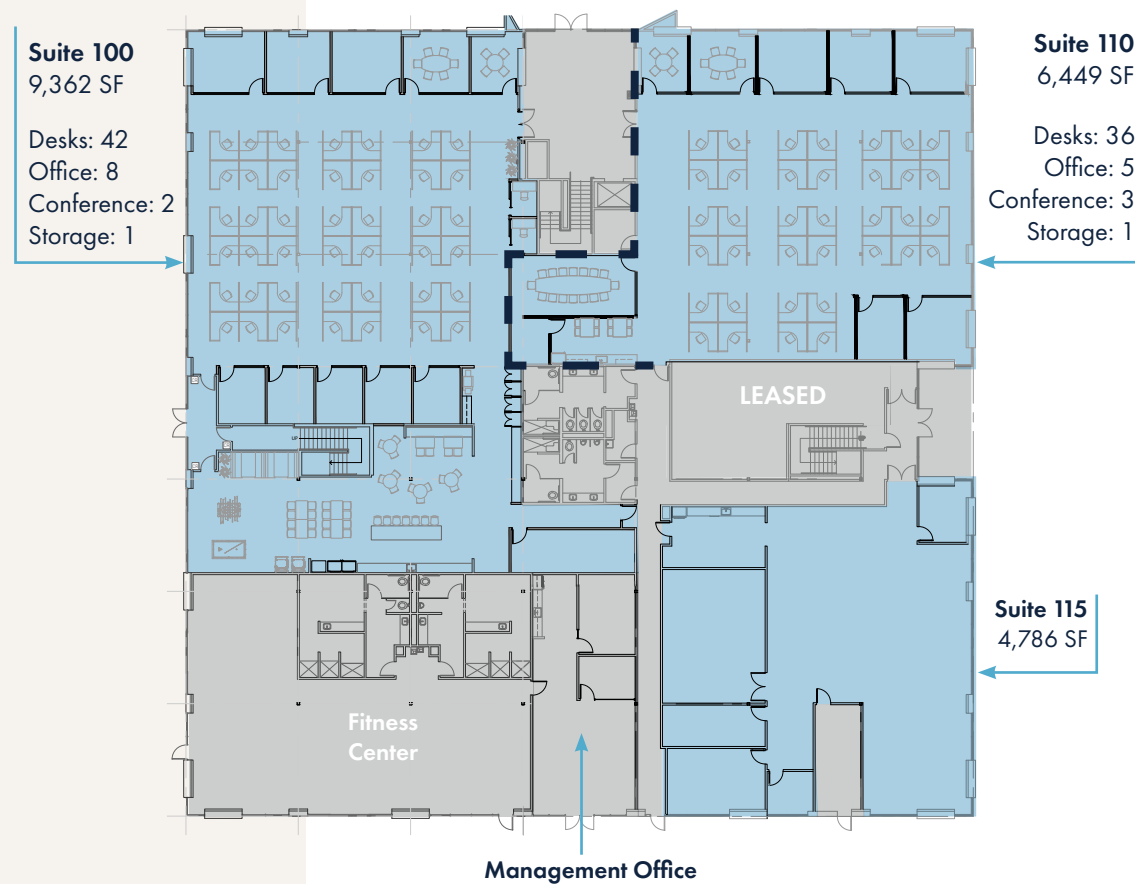



# LOCATION ADVANTAGES

The Quad at Tasman sits in the coveted Golden Triangle between **Highway 101, SR 237, and I-880**, with quick access to nearby entertainment, amenities, and major transport hubs.



**130+**

Nearby dining and retail amenities

**ADJACENT**

To VTA Light Rail

**DIRECT**

Access to Hwy 101 and SR 237

**20-25 MIN**

Drive to San Jose Airport and SFO

SANTA CLARA

8 MINUTES

@FIRST

- Target
- Fresh & Easy
- CVS Pharmacy
- The Coffee Bean & Tea Leaf
- Chipotle Mexican Grill
- Chick-fil-A
- Five Guys
- Panera Bread
- Panda Express
- Pasta Pomodoro
- Sweet Tomatoes
- Sprint
- Chase Bank
- Union Bank
- Supercuts

Aloft Santa Clara

Hyatt Regency Santa Clara

Santa Clara Convention Center



Hilton Santa Clara

Patrick Henry Station  
\*Adjacent to the Property

Santa Clara Marriott

Avatar Hotel Santa Clara, Tapestry Collection by Hilton

10 MINUTES

NICHOLSON PLAZA

- Subway
- Round Table Pizza
- La Catalana
- Sendo Sushi
- Mina's Korean BBQ
- Halal Gyro Express
- Vons Chicken
- Sri's Kitchen
- First Mart

13 MINUTES

MCCARTHY RANCH MARKETPLACE

- Best Buy
- PetSmart
- Walmart
- Men's Warehouse
- Ross
- Sprint Store
- Verizon Wireless
- Applebee's
- Black Angus
- Cinnamon Club
- Asian Grill
- Home Town Buffet
- Green Cafe
- Macaroni Grill
- On The Border
- Pasta Pomodoro
- Red Kwali
- Specialty's Café
- Sushi King
- Happi House
- In-N-Out Burger
- McDonald's
- Starbucks
- Subway
- Taco Bell
- Taqueria Los Cunados
- Togo's
- Tutti Frutti
- Hilton Garden Inn
- Larkspur Landing

13 MINUTES

RIVERMARK

- Safeway
- Chipotle Mexican Grill
- Red Robin
- Posh Bagel
- Coldstone Creamery
- Yo Yo Sushi
- Premier Pizza
- Mezbaan Bar & Indian
- Piatti
- Peet's Coffee & Tea
- Starbucks
- Fantasia Coffee & Tea
- Gamestop
- New Balance Footwear
- Wells Fargo Bank
- Supercuts
- The Bar Method
- River Mark Nail Spa
- Hyatt House Santa Clara

15 MINUTES

THE GREAT MALL

- Sears
- Kohl's
- Burlington Coat Factory
- Banana Republic
- Gap
- H&M
- Marshall's
- Nike
- UNIQLO
- Victoria's Secret
- Toys in Motion
- Sports Authority
- Home Depot
- Dave & Busters
- Olive Garden
- Red Robin
- Outback Steakhouse
- Starbucks
- Subway

12 MINUTES

RIVER OAKS PLAZA

- Starbucks
- Mountain Mike's Pizza
- Subway
- Tortilla House
- Talab
- Bibimbowl
- Chase Bank

12 MINUTES

THE MARKETPLACE

- Bank of America
- Carl's Junior
- Subway
- Starbucks
- Specialty's Cafe & Bakery
- Premier Pizza
- Pho Viet
- Philly's Cheesesteaks
- Okyahma Express
- Una Mas
- Thai Orchard
- Dish n' Dash
- Homewood Suites

7 MINUTES

SANTA CLARA SQUARE

- Barebottle Brewing
- Chipotle Mexican Grill
- Eureka!
- Fleming's Steakhouse
- Gong Cha
- The Halal Guys
- Il Fornaio
- Jaks
- Lee's Sandwiches
- Mountain Mike's Pizza
- Opal
- Pacific Catch
- Puesto
- Starbucks Coffee
- Whole Foods Market
- Chase Bank
- Club Pilates
- CorePower Yoga
- OrangeTwist
- Sephora

8 MINUTES

MERCADO CENTER

- AMC Mercado 20
- In-N-Out Burger
- Jamba Juice
- Krispy Kreme
- Mexicali Grill
- Panda Express
- SmokeEaters
- Starbucks
- Subway
- TJ Maxx
- Walmart Neighborhood Mrkt



101

San Jose International Airport

To Downtown San Jose/  
Diridon Caltrain

San Jose Municipal Golf Course

Milpitas Station  
\*20 mins from the Property

E CALAVERAS BOULEVARD  
LOS COCHES STREET  
S PARK VICTORIA DRIVE

880

237

WTASMAN DRIVE

ZANKER ROAD

AGNEW ROAD

MONTAGUE EXPRESSWAY

NORTH SAN JOSE

N FIRST STREET

ZANKER ROAD

EL PASO DRIVE

E CAPITOL AVENUE



# THE QUAD

## AT TASMAN

### BRANDON BAIN

+1 408 615 3416  
brandon.bain@cushwake.com  
Lic #01308375

### ERIK HALLGRIMSON

+1 408 615 3435  
erik.hallgrimson@cushwake.com  
Lic #01274540

### KATE MYERS

+1 408 502 0196  
kate.myers@cushwake.com  
Lic #02253804

