

# BUILDING 4400 - SUITE 120 - SPEC LAB SUITE

~7,691 RSF

## LAB PORTION

- Single Pass Air
- (4) Lab Support Rooms
- (4) Combination Emergency Shower and Eyewash Stations
- Shipping and Receiving

## OFFICE PORTION

- 2 Huddle Rooms
- 2 Conference Rooms
- 1 Mother/Wellness Room
- 2 Storage Rooms
- 1 IT/Server Room
- Break Room with Appliances
- Copy Area
- Reception Area

*\*Hypothetical furniture plan*

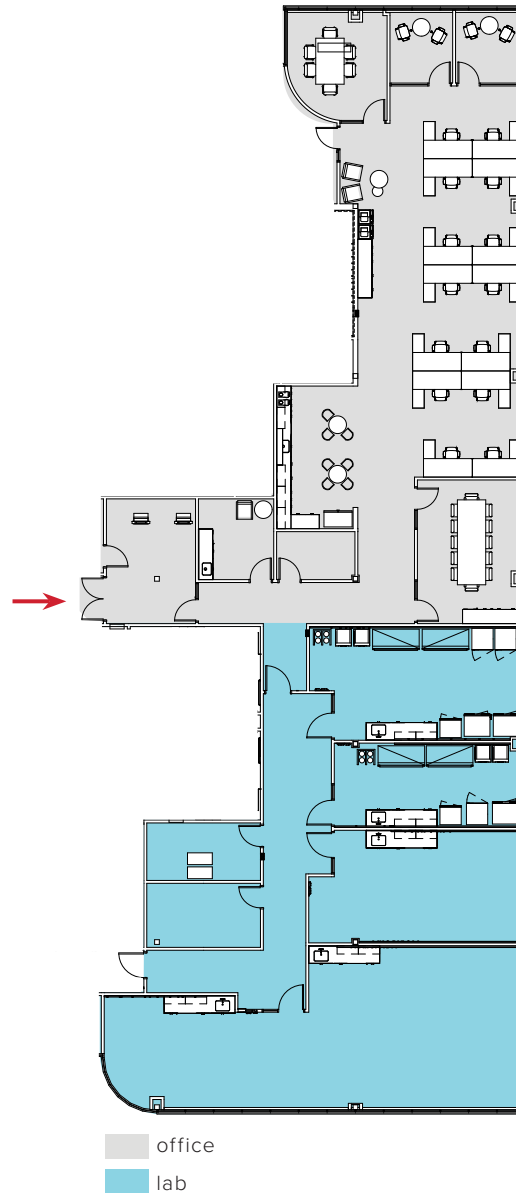

## SITE PLAN:

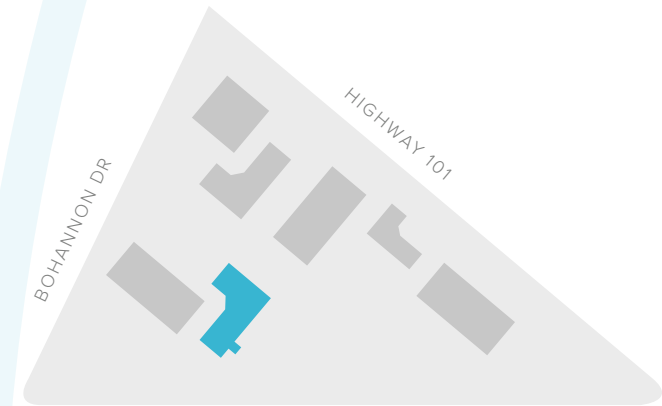

## KEY PLAN:

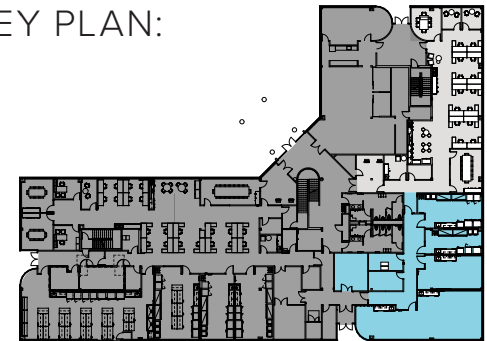

**BEN PAUL** | Vice Chairman | +1 650 401 2123 | ben.paul@cushwake.com | LIC #0121087

**GARY BOITANO** | Managing Director | +1 650 401 2122 | gary.boitano@cushwake.com | LIC #01902693

**DAVID HIEBERT** | Vice Chairman | +1 650 320 0250 | david.hiebert@cushwake.com | LIC #01189320