

BUILDING 4400 - SUITE 120 - SPEC LAB SUITE

~6,808 RSF

LAB

Single Pass Air

(4) Lab Support Rooms

(4) Combination Emergency

Shower and Eyewash Stations

Shipping and Receiving

Plug and Play / Benching

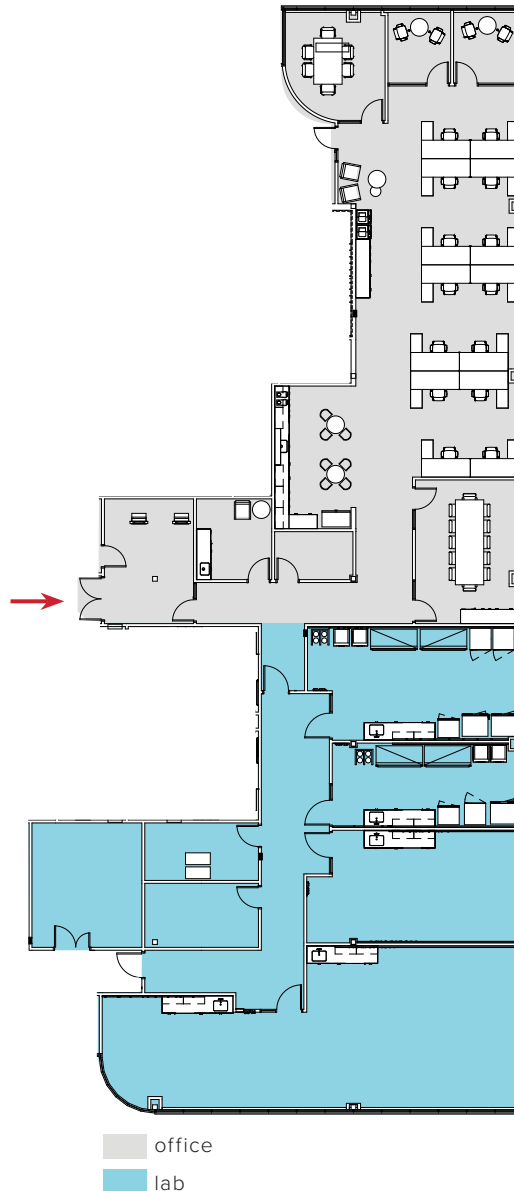

SITE PLAN:

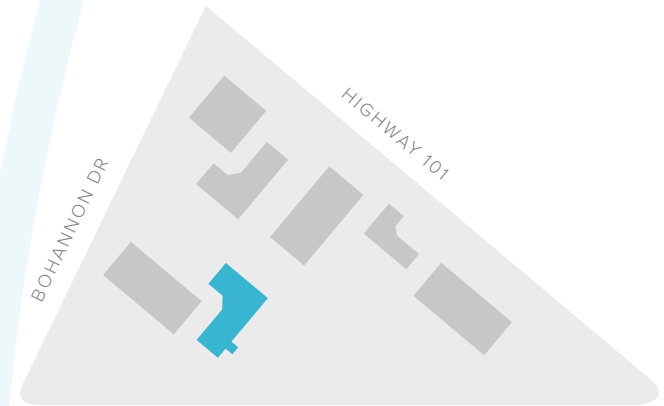

OFFICE

2 Huddle Rooms

2 Conference Rooms

1 Mother/Wellness Room

2 Storage Rooms

1 IT/Server Room

Break Room with
Appliances

Copy Area

Reception Area

KEY PLAN:



BEN PAUL | Vice Chairman | +1 650 401 2123 | ben.paul@cushwake.com | LIC #0121087

GARY BOITANO | Managing Director | +1 650 401 2122 | gary.boitano@cushwake.com | LIC #01902693

DAVID HIEBERT | Vice Chairman | +1 650 320 0250 | david.hiebert@cushwake.com | LIC #01189320