

SLASH

3534 Hayden Avenue

IGNITE YOUR IMAGINATION

Slash is a workplace for visionaries located in the Hayden Tract community. Spanning 21,650 square feet, this light-filled environment offers endless possibilities for creativity, anchored by an expansive private patio designed to spark new, groundbreaking ideas.

Featuring a unique, saw-tooth patterned roof designed by Eric Owen Moss Architects, this Westside space reflects a distinct style that embodies outside-the-box innovation. Positioned in a creative hub alongside industry giants like HBO, Apple, and Disney Digital and just steps from premier dining and retail, Slash channels the vibrant energy of Culver City.



AVAILABLE NOW: 21,650 RSF



ARTFULLY CRAFTED WORKSPACES

With expansive floorplans, tall, airy ceilings and towering, glass-walled offices, Slash welcomes in abundant natural light to provide an inspiring and productive setting.

AVAILABLE NOW: 21,650 RSF



MEZZANINE FLOOR PLAN

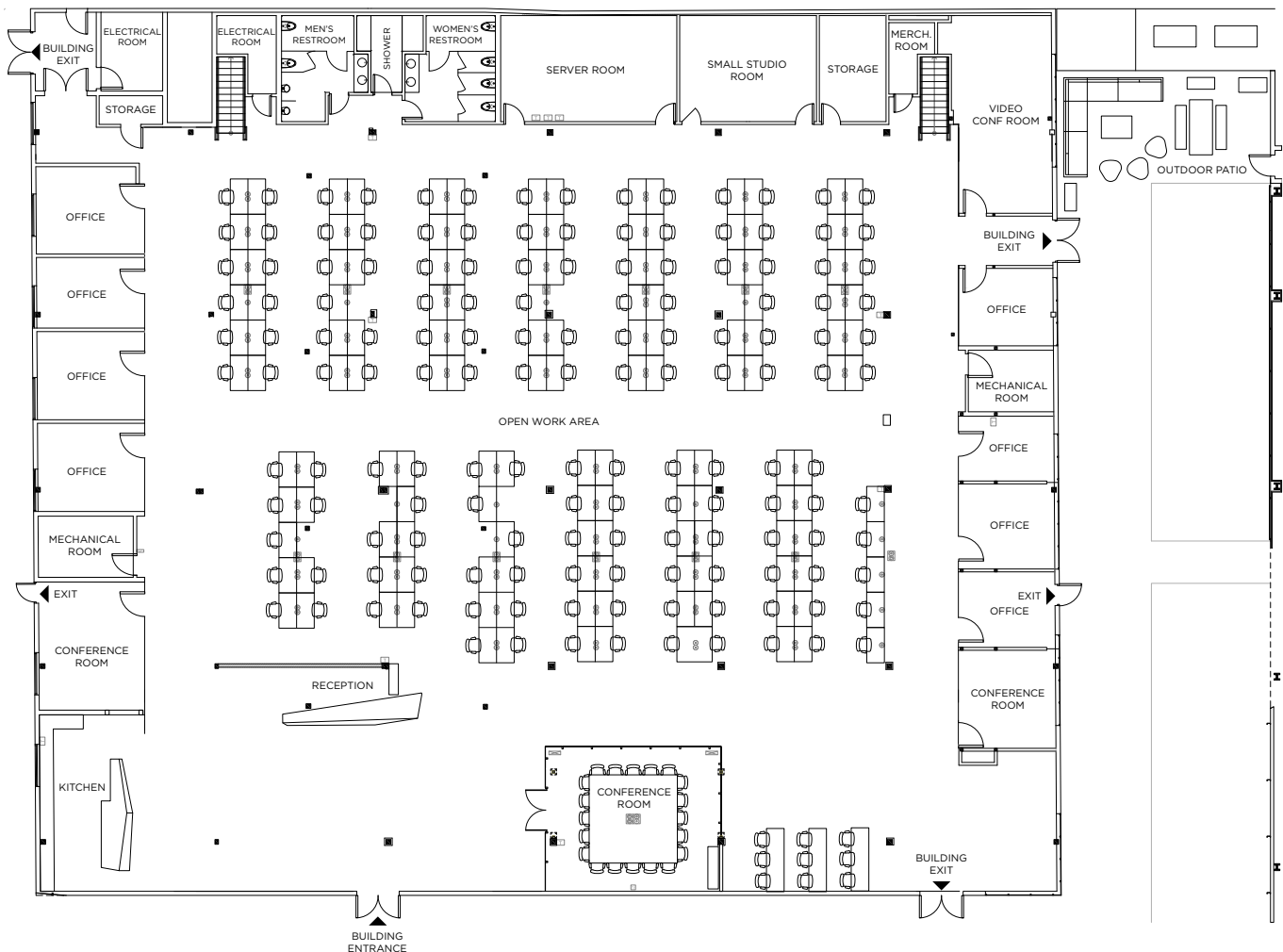

FIRST FLOOR PLAN

THE FOREFRONT OF LA'S CREATIVE SCENE



Thrive in the creative office epicenter of the Westside, surrounded by industry leaders like Amazon, UCLA, and Apple. This dynamic location offers a hub of inspiration, providing endless opportunities to connect and collaborate with top minds in tech, media, and entertainment.



BALLONA CREEK BIKE PATH

METRO EXPO LINE

PARKING RATIO: 3:1,000 RSF
\$175 UNRESERVED | \$275 RESERVED

YOUR LINK TO THE CITY

With easy access to I-405 and I-10, Slash puts you minutes from West Los Angeles, Santa Monica, and Century City, streamlining your daily commute. The nearby Ballona Creek Bike Path, a favorite among walkers, runners, and bikers, offers a scenic route straight to Santa Monica Bay, connecting you to the best of the Westside.



For More Information, Please Contact:

GABRIEL BROWN

+1 310 435 4344
gabe.brown@jll.com
CA Lic. 01441920

JOSH BERNSTEIN

+1 310 795 5947
josh.bernstein@cushwake.com
CA Lic. 01828093

ALEXA DELAHOKE

+1 626 340 5391
alexa.delahooke@cushwake.com
CA Lic. 02091695

©2025 Cushman & Wakefield. All rights reserved. The information contained in this communication is strictly confidential. This information has been obtained from sources believed to be reliable but has not been verified. NO WARRANTY OR REPRESENTATION, EXPRESS OR IMPLIED, IS MADE AS TO THE CONDITION OF THE PROPERTY (OR PROPERTIES) REFERENCED HEREIN OR AS TO THE ACCURACY OR COMPLETENESS OF THE INFORMATION CONTAINED HEREIN, AND SAME IS SUBMITTED SUBJECT TO ERRORS, OMISSIONS, CHANGE OF PRICE, RENTAL OR OTHER CONDITIONS, WITHDRAWAL WITHOUT NOTICE, AND TO ANY SPECIAL LISTING CONDITIONS IMPOSED BY THE PROPERTY OWNER(S). ANY PROJECTIONS, OPINIONS OR ESTIMATES ARE SUBJECT TO UNCERTAINTY AND DO NOT SIGNIFY CURRENT OR FUTURE PROPERTY PERFORMANCE. COE-PM-West-06.9.2025

